

PLYMOUTH VILLAGE

ADVENTURE HOUSING DEVELOPMENT

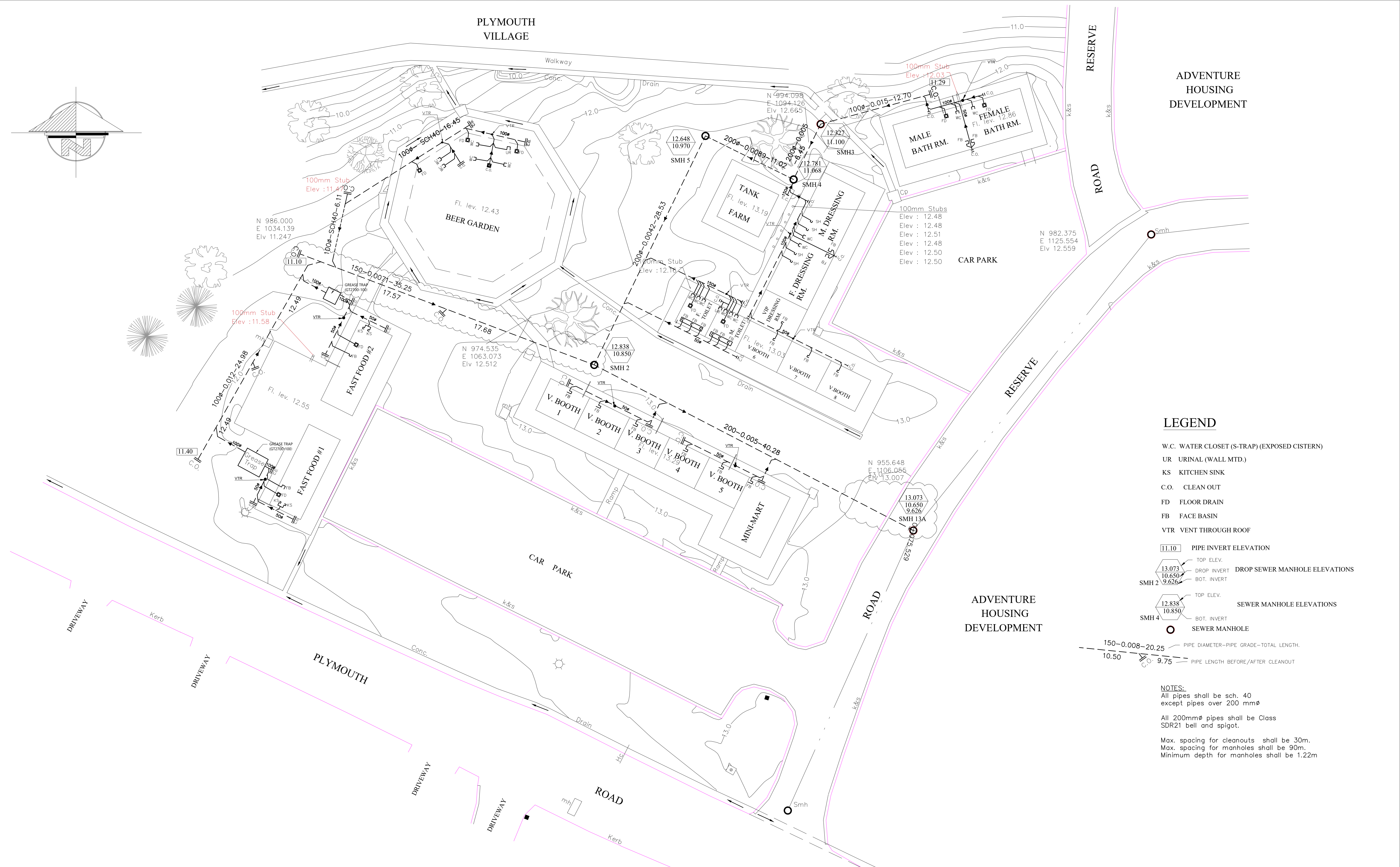
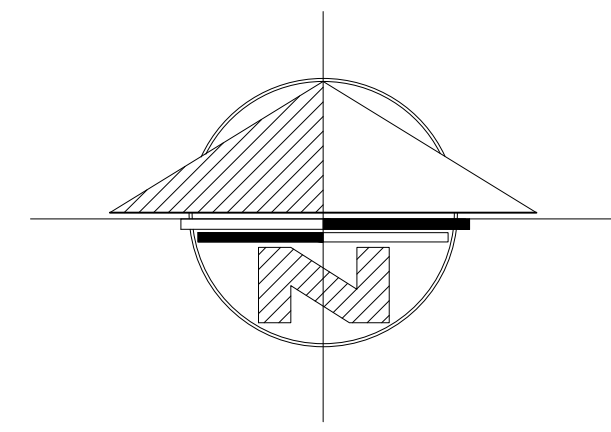

LEGEND

- W.C. WATER CLOSET (S-TRAP) (EXPOSED CISTERN)
- UR URINAL (WALL MTD.)
- KS KITCHEN SINK
- C.O. CLEAN OUT
- FD FLOOR DRAIN
- FB FACE BASIN
- VTR VENT THROUGH ROOF
- 11.10 PIPE INVERT ELEVATION
- 13.073 TOP ELEV.
10.650 DROP INVERT
9.626 BOT. INVERT DROP SEWER MANHOLE ELEVATIONS
- SMH 2
- 12.838 TOP ELEV.
10.850 BOT. INVERT SEWER MANHOLE ELEVATIONS
- SMH 4
- SEWER MANHOLE
- 150-0.008-20.25 PIPE DIAMETER-PIPE GRADE-TOTAL LENGTH.
- 10.50 9.75 PIPE LENGTH BEFORE/AFTER CLEANOUT

NOTES:
 All pipes shall be sch. 40 except pipes over 200 mmØ
 All 200mmØ pipes shall be Class SDR21 bell and spigot.
 Max. spacing for cleanouts shall be 30m.
 Max. spacing for manholes shall be 90m.
 Minimum depth for manholes shall be 1.22m

PROPOSED ADVENTURE MINI MALLS AND RECREATION PARK PROJECT

NO.	DATE	REVISION	INITIALS
1	1/4/2019	Removal of line between MH 1 and 2 and replacing with 150dia pipe	AM
2	1/4/2019	Removal of line MH 1 and addition of drop manhole to MH 13A	AM
3	1/4/2019	General adjustment in grades and inverts of pipes and Manholes	AM

CLIENT:	DIVISION OF COMMUNITY DEVELOPMENT AND CULTURE, TOBAGO HOUSE OF ASSEMBLY
ENGINEER:	DIVISION OF INFRASTRUCTURE QUARRIES AND THE ENVIRONMENT, TOBAGO HOUSE OF ASSEMBLY
DWG. TITLE:	SEWER WASTE WATER PLAN



DESIGNED	A. MARTIN
DRAWN	A. MARTIN
CHECKED	
DATE	APR 2018
SCALE	AS SHOWN
DWG. NO.	AMMRP-C01